

DRAFT
01/2009

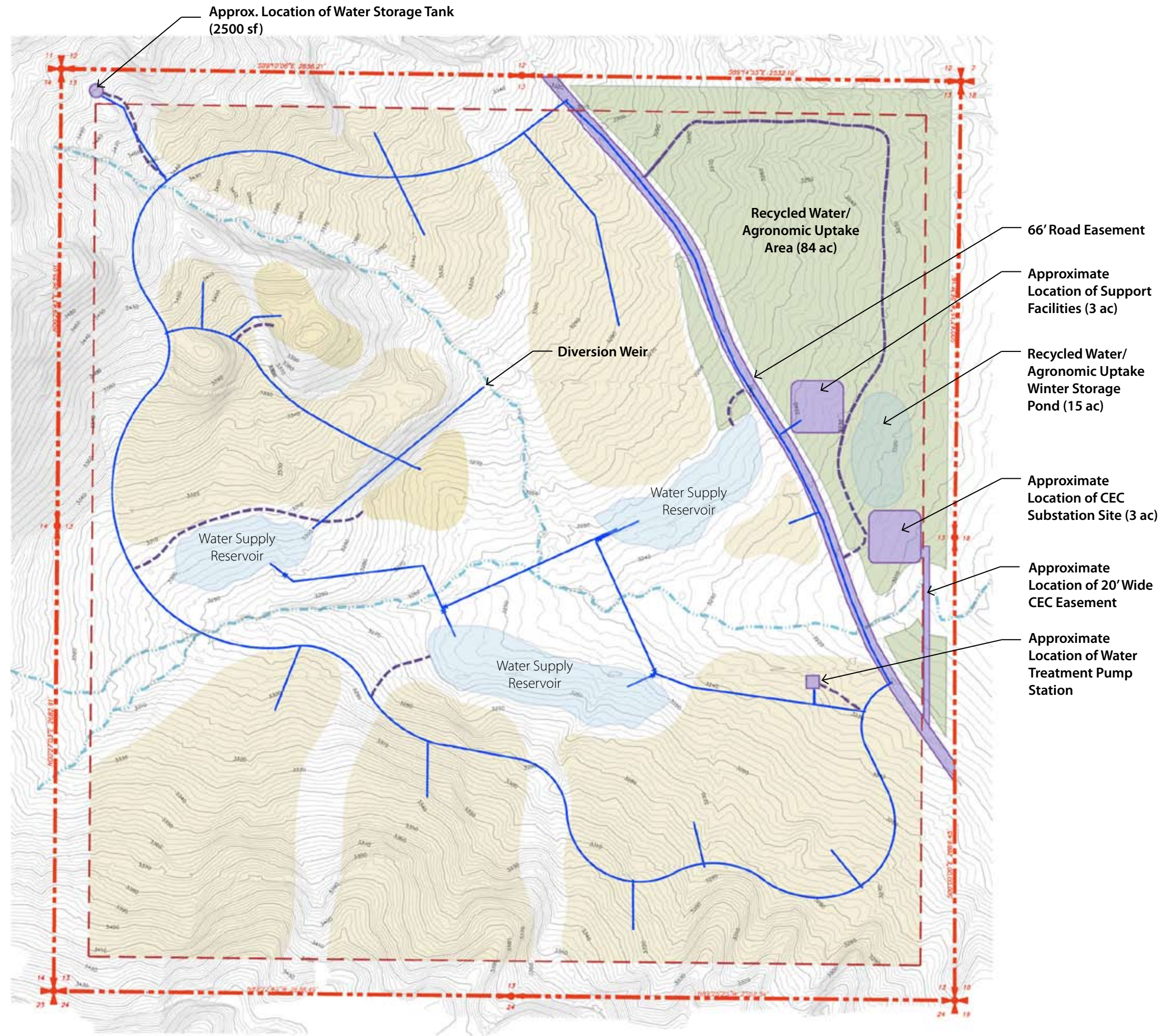

LEGEND

- Utility Easement (Approx. Location)
- Development Area
- Recycled Water/Agronomic Uptake Area
- Property Line
- 200' Voluntary Fire Setback
- Seasonal Drainageway
- Water Transmission Main and Wastewater Collection Main (Minimum 10' separation)
- Utility Access Road (Approx. Location)
- 10' Contour
- 2' Contour

NOTES:

- Water Transmission Main to follow site roads. See Exhibit 11.
- Water and Wastewater Main locations are approximate.